

GLBA WARM & FUZZY CASUAL HORSE SHOW

SATURDAY, MAY 9, 2009

9:00 a.m. rain, shine or snow!

SAGINAW CO. FAIRGROUNDS,

CHESANING, MI

Judge: Lynnette Gorman



Sponsored by the

Great Lakes Buckskin Youth Team

NO SHOW CLOTHES REQUIRED!

1. Showmanship 20 & Over
 2. Showmanship 14-19
 3. Showmanship 13 & Under
 4. Showmanship – PeeWee (9 & Under) *
 5. Showmanship – Grooms **
 6. Halter – Mares 3 & Over
 7. Halter – Stallions/Geldings 3 & Over
 8. Halter – 2 & Under
 9. Halter – Pony
- *****10 MINUTE BREAK*****
10. English Equitation 20 & Over
 11. English Equitation 14-19
 12. English Equitation 13 & Over
 13. English Equitation – PeeWee W/T (9 & Under)*
 14. English Equitation – Grooms W/T**
 15. English Pleasure 20 & Over

16. English Pleasure 14-19
 17. English Pleasure 13 & Under
 18. English Pleasure – Pony
 19. English Pleasure – PeeWee W/T (9 & Under)*
 20. English Pleasure – Grooms W/T **
- *****LUNCH *****
21. Pee Wee Lead Line – 6 & Under
 22. Bareback 14 & over
 23. Bareback 13 & Under
 24. Ride-a-Buck – Open
 25. Ride-a-Buck Walk/Trot
 26. Horsemanship 20 & Over
 27. Horsemanship 14-19
 28. Horsemanship 13 & Under
 29. Horsemanship Pee Wee W/T (9 & Under) *
 30. Horsemanship – Grooms **
 31. Open Jackpot Western Pleasure
 32. Western Pleasure 20 & Over
 33. Western Pleasure 14-19
 34. Western Pleasure 13 & Under
 35. Western Pleasure - Pony
 36. Western Pleasure – Pee Wee W/T* (9 & Under)
 37. Western Pleasure – Grooms W/T**
- *****10 MINUTE BREAK*****
38. Simon Says 14 & Over
 39. Simon Says 13 & Under
 40. Simon Says Walk/Trot
 41. Egg & Spoon 14 & Over
 42. Egg & Spoon 13 & Under
 43. Egg & Spoon - Walk/Trot
 44. Surprise Class 14 & Over
 45. Surprise Class 13 & Under
 46. Surprise Class Walk/Trot

*Denotes Pee Wee classes. Pee Wee's cannot participate in any other classes.

**Denotes Grooms class. This is a walk/trot class for any age other than Pee-Wees.

One horse/one rider combination per age division.

There is a 3 minute gate call. When the gate closes the class is closed. No late entries will be permitted.

www.greatlakesbucksin.com

GENERAL SHOW POLICIES

- Age as of January 1.
- Ponies to show in age group class, where no pony class is offered.
- State law requires proof of negative Coggins Certificate within the current year.
- Public address system is merely a courtesy – please pay attention to activity in the arena.
- Stallions must be handled by adults
- All dogs must be leashed.
- Unsportsmanlike conduct will NOT be tolerated. Unsportsmanlike conduct will result in removal from show grounds.
- Under the Michigan equine activity liability act, an equine professional is not liable for an injury to or the death of a participant in an equine activity resulting from an inherent risk of the equine activity.
- Training Equipment allowed.
- No show clothing required. Must wear boots.

CLASS FEES:

- \$3 per class for all classes (except jackpot)
- \$5 Jackpot Class (75% payback to 1st-3rd places)
- \$1 per horse office fee
- \$35 fee for each NSF Check

Jill Drury, 2830 S. Evergreen, White Cloud, MI 49349, questions call 231-689-6229. Email: jdrury@mwconnections.com

A: 11350 Peet Rd, Chesaning, MI 48616-9503

Print map type:

[My Map](#) [Revert to Default Map](#)

[Back to Map](#)

MAPQUEST.

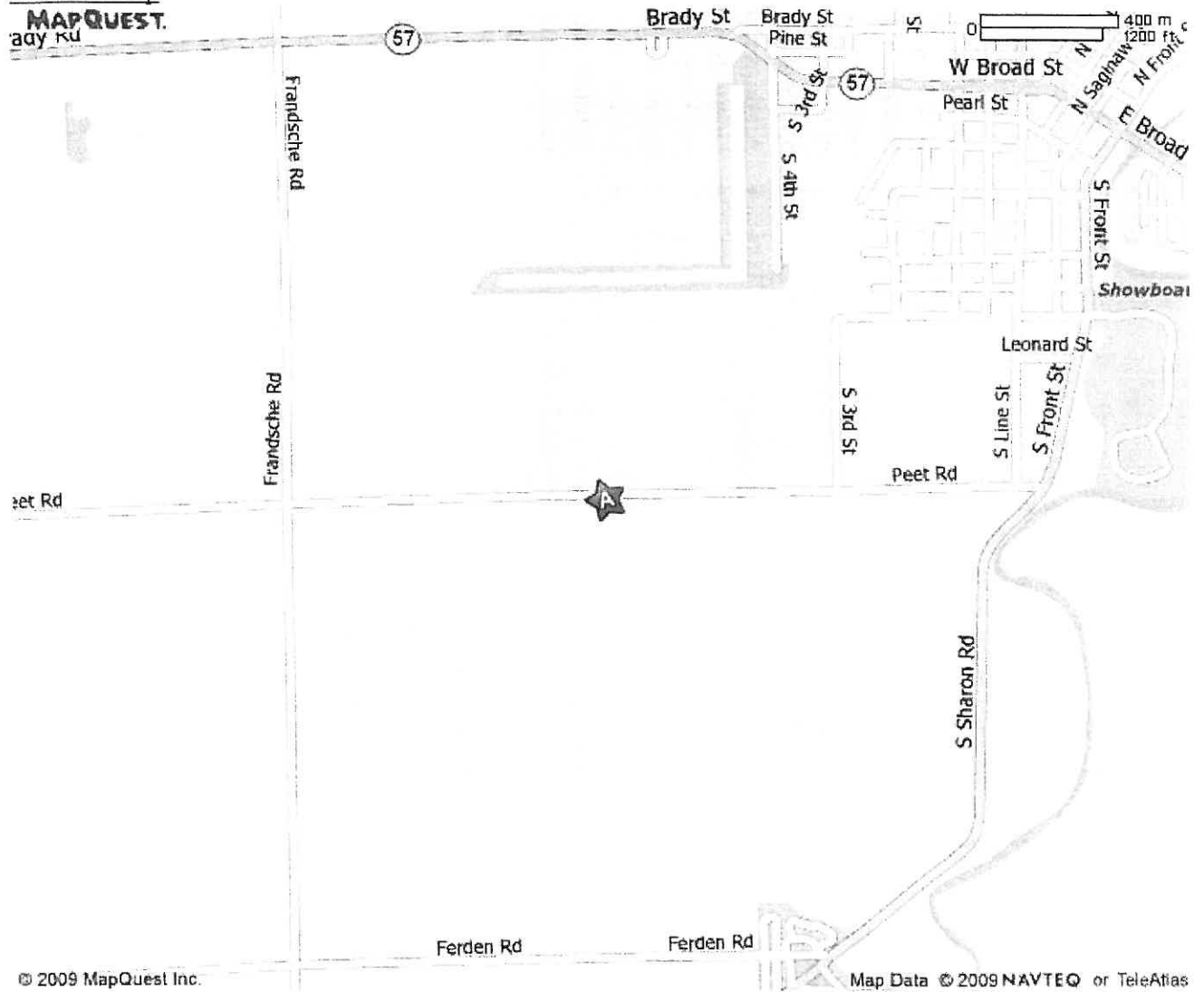

© 2009 MapQuest Inc.

Map Data © 2009 NAVTEQ or TeleAtlas